

to Col. Co. Rt 18

(Highway leading from
Braidwood St. to Rayville)

E 1 AD

IPS N 15° 30' 30" E 8200 N 21° 14' 40" E 75.09'
IPS N 22° 54' 00" E 43.24'
IPS 43.24'

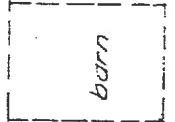

REMAINING LANDS OF
DENGLER

S 69° 46' 10" E 300.00'



PORTION TO BE CONVEYED
7.33 ACRES

124.6'



142.6'

3.6' Ocell

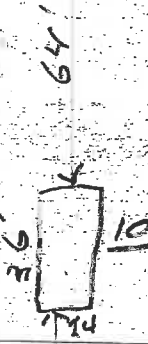

3.6'

10'

200'

59.5'

stone wall & wire fence

N 69° 46' 10" W 300.00'

IPS denotes iron pipes

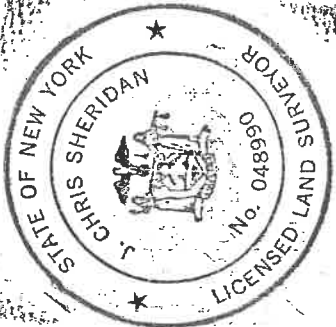

LANDS N/F RUDOLF W. &
JOANNE DETTMER

PLAT OF SURVEY
PREPARED FOR
HERBERT & DARLENE JONES
OF LANDS SITUATE IN
TOWN OF NEW LEBANON
COLUMBIA COUNTY, N.Y.
SCALE: 1" = 50' SEPTEMBER 1979

House Location

By J.C. Sheridan 10/11/79

J. Chris Sheridan, L.S.